



## KNIFE-GATE VALVES

## L SERIES

### CHAINWHEEL

- Widely used in raised installations with difficult access, the handwheel is fitted in vertical position.
- **A = Max. width** of the valve (without actuator).  
**B = Max. height** of the valve (without actuator).  
**C = maximum length** when the gate is centred.
- Options:
  - Locking devices.
  - Extensions: stand, pipe, plates...
  - Non-rising stem.
  - ND higher than those give in the table.
- Including:
  - Handwheel
  - Stem
  - Nut
  - Hood
  - Chain
- Available: ND50 to ND1200, other ND on request.
- The weights are approximate and vary according to the material and the valve's accessories.
- From ND 600, the valves are with gear box, see \* in the table.

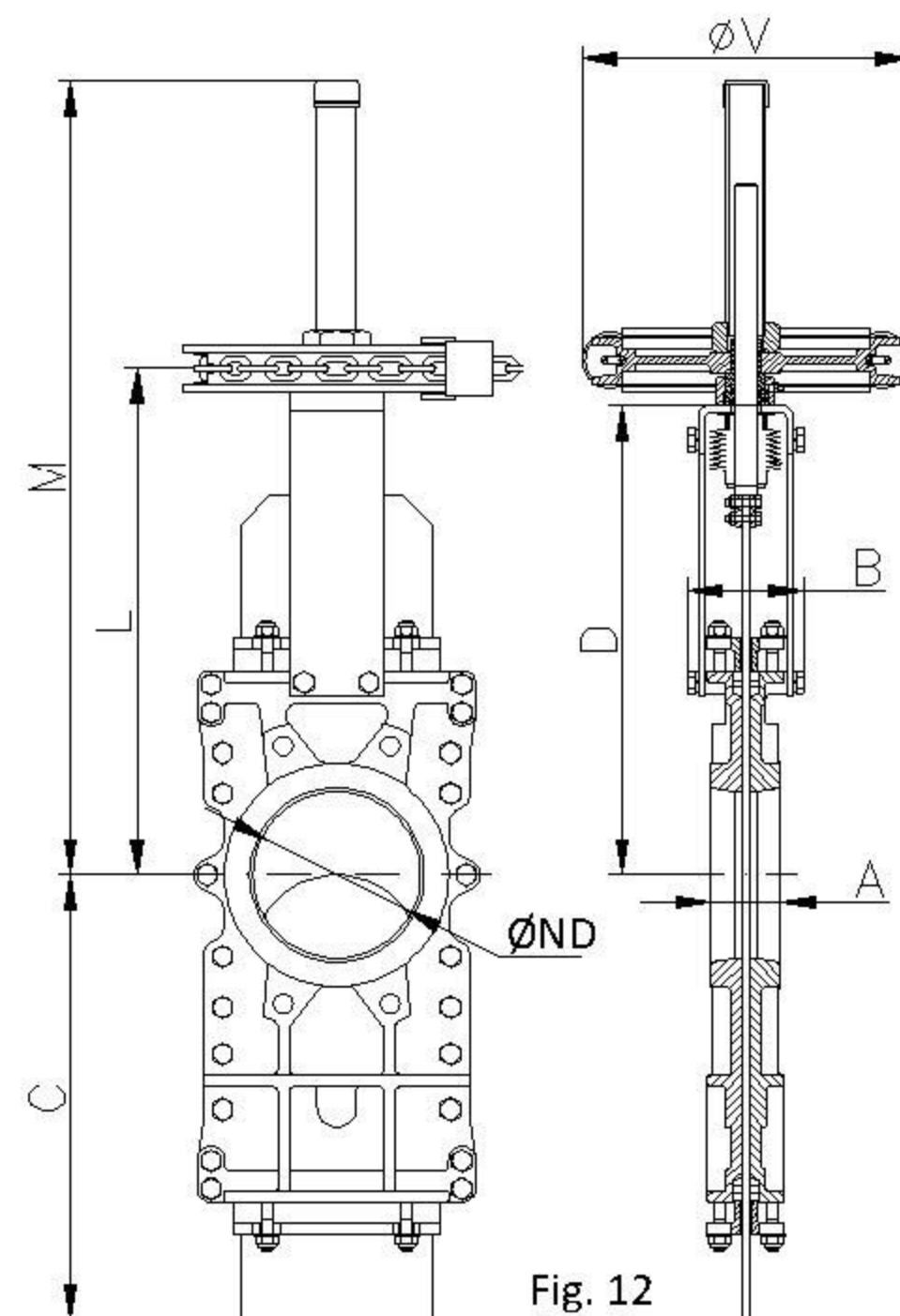

Fig. 12

ND	$\Delta P$ (Kg/cm <sup>2</sup> )	DRAW (Nw)	TORQUE (Nm)	A	B	C	D	L	M	$\varnothing V$	Weight (kg.)
50	10	894	2.1	40	91	225	243	294	437	225	12
65	10	1508	3.5	40	91	265	269	319	464	225	13
80	10	2281	5.2	50	91	310	293	346	490	225	17
100	10	3561	8.2	50	91	370	334	386	530	225	19
125	10	5565	13	50	101	430	367	420	613	225	28
150	10	6419	15	60	101	495	419	471	665	225	38
200	8	10020	29	60	118	630	525	602	849	300	54
250	6	11230	32.5	70	118	770	620	697	1050	300	88
300	6	16210	47	70	118	895	704	797	1150	300	112
350	5	17740	70	96	290	1050	780	918	1398	402	163
400	5	23260	92	100	290	1185	855	998	1504	402	235
450	3	22260	89	106	290	1320	975	1078	1690	402	368
500	3	27470	110	110	290	1455	1064	1201	1802	402	471
600	3	39850	160	110	290	1720	1244	1329	2108	402	532
700	2	36880	212	110	320	1995	1425	1606	2406	402*	936
800	2	48980	285	110	320	2230	1615	1820	2720	402*	N.G.
900	2	61230	353	110	320	2465	1823	2053	3053	402*	N.G.
1000	2	77690	457	110	320	2620	1992	2257	3337	402*	N.G.
1100	2	95506	674	150	340	3030	2217	2546	3676	402*	N.G.
1200	2	113710	802	150	340	3250	2351	2836	4016	402*	N.G.

N.G.: Weight not given

table 5